

HOUSEFLY
TRAP

FIRST TIME IN INDIA

Users Manual

BarrixTM
One for everyone

BARRIX CATCH

Domo Trap & Lures for Housefly



**Innovative, Patented, Research Based, Scientifically
Designed & Highly Effective Domo Trap for Housefly**

Flagship Product from
Barrix Innovation Center

Musca domestica is also known as house fly or cosmopolitan pest. House fly have long been a noxious, nuisance pest and harmful to living organisms.

These are good carriers of communicable diseases such as

- Fly plagues
- Anthrax
- Avian cholera
- Fowl pox
- Avian tuberculosis
- Bird flu
- Botulism
- *E.coli* infections
- Diarrhea
- Bacillary dysentery
- Typhoid & para typhoid
- Salmonellosis
- Helminthic infections
- Ophthalmic infections
- Poliomyelitis
- Myiasis
- Mycoplasma
- IBDV and viral infections.

House flies collect pathogens using their legs, hair that cover their body and their feces. They can contaminate food and other exposed surfaces.

Each female fly can lay up to 500 eggs in a lifetime, in several batches of about 75 to 150. Within a day, maggots hatch from eggs; they live and feed on decaying material.

Current practices to control the housefly menace involves the application of insecticides, use of chromatic traps, electrocution traps, burning of peat and other physical ways.

But results are not encouraging, and it impacts on yield, spread of diseases on non target living organisms which includes human beings suffering from almost 60 odd diseases. So there is a need for an effective, salient, non-messy device.

So what's the solution?

Our new invention which is scientifically developed, patented, very effective, non-messy device - Barrix Catch Domo trap & its semio-chemicals lures like Phero Lure & Kairo Lure.

Our barrix catch domo trap, sustained released AVP matrix lure along with kairo lure formulations for monitoring of *Musca domestica* is the only solution which don't need to spray, don't need electricity, easy to use, no special skilled labours required, zero maintenance.

Technology Involved:

- ✓ Barrix AVP Matrix Technology
- ✓ Fly pattern block technology
- ✓ Colour alluring technology
- ✓ Rain protection technology
- ✓ UV protection technology

Special Features of Barrix Domo Trap:

- Patented & Scientifically designed.
- Trap thermally stable & recyclable.
- Protect Lure from UV rays.
- Sturdy at all climatic conditions.
- Research based pest alluring colour.
- Long lasting performance.
- Ample holding capacity upto 30,000 flies.

Superior features of Barrix Housefly Lures:

- Contains highly pure para-pheromones
- Kairo / Phero lures are toxic free
- Uses highly successful aggregate pheromones
- Sustain release through AVP matrix
- Bio-degradable formulation

A Set of Housefly Trap Contains:

- Domo Trap - 1 Unit
- Phero Lure - 25g x 4 Nos.
- Kairo Lure - 30g x 4 Nos.

Parts of Domo Trap



Base Bowl



Collar



Cone



Transparent Cap



Phero Lure



Kairo Lure

For Monitoring Purpose Only. This is not a pesticide.

BARRIX CATCH



Domo Trap & Lures for Housefly

Where to use:

- ◆ Livestock areas of Poultry, Cattle sheds, Piggery, Fishery, Horse stables etc.
- ◆ Food Processing Units
- ◆ Butcher/Meat Shops
- ◆ Hospitals
- ◆ Bakery
- ◆ Juice Shops
- ◆ Hotels & Party Halls
- ◆ Houses
- ◆ Dumping yard



How many to use:

1 trap for every 300 sq.ft to 500 sqft.

If the density of housefly population is more then the number of traps can be increased.

How to use:

1. Cut open the Kairo Lure pouch and add contents to the base bowl, add 150ml of water and stir.
2. Squeeze the Phero Lure contents on the rims of perforated cone.
3. Place the applied Phero Lure cone on the collar.
4. Now fit the transparent cap to the collar.
5. The assembled device can be placed on the ground or shall be hanged at the height of 1 to 2ft above the ground.
6. After the installation, monitor the trap everyday to know the population density and trap filling level for emptying it.
7. If the trap is completely filled, empty it and clean with water as shown in picture.
8. Apply a fresh Barrix Catch Phero Lure and Kairo Lure.

Method of installation:

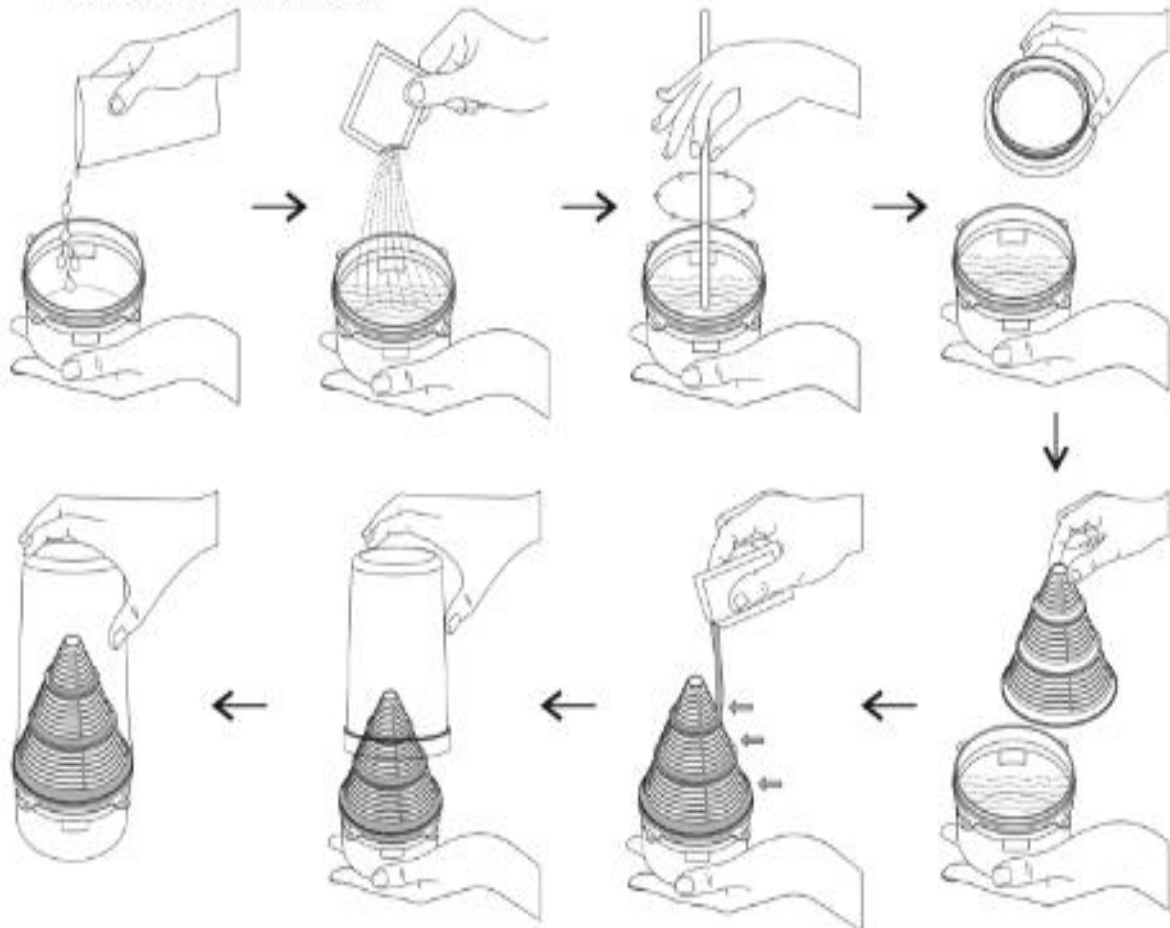

Trap installation patterns:

